

FEATURES

- » Durable Welded Metal Construction
- » Electrostatic Powder Coating
- » Wall Mounting Holes on Rear Top
- » Adjustable Slotted Shelves with Shelf Clip
- » Reinforced Doors with Concealed Hinges and Anti-Noise Plastic Buffers
- » 1.000 Differs 2 Point Flush Handle Lock with 2 Keys (Paired Lock)
- » Key Duplicate Support
- » Masterkey Support
- » Packaging: Nylon Bag + Corrugated Carton

STANDARD COLORS FOR THIS RANGE

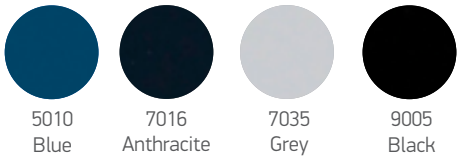

- » Non-standard colors are available with price difference (extra charge)
- » Production codes are referring items completely in color Grey 7035

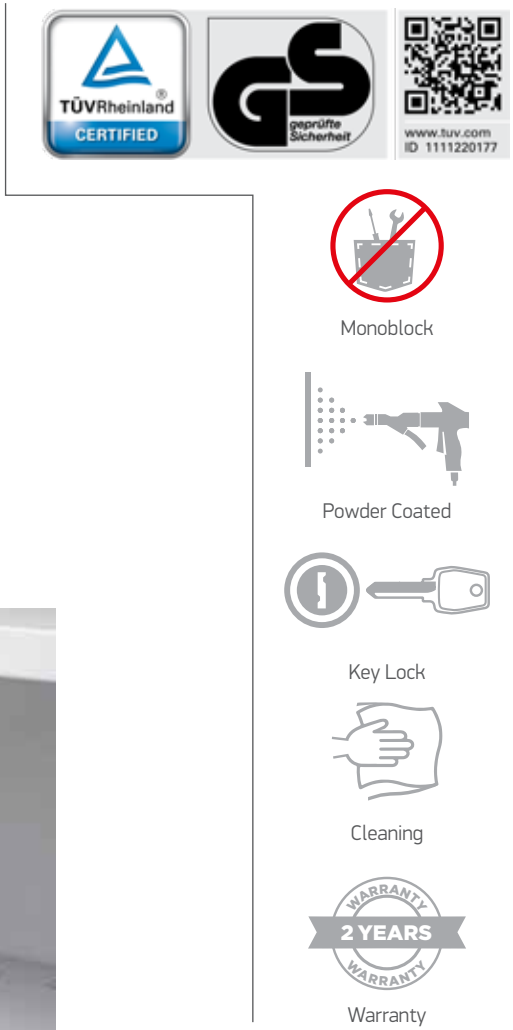
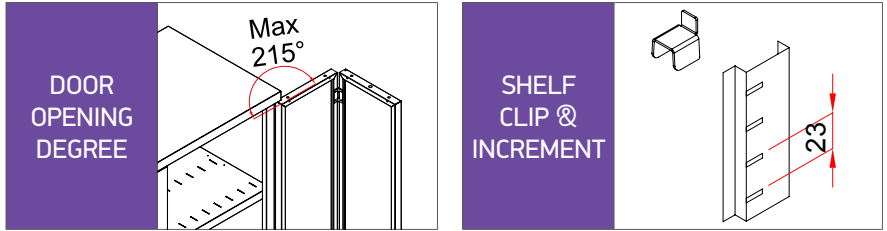

view		
catalogue code	WSC-0043	WSC-0044
production code	152M0901-00055	152M0901-00056
type of door	2 swing	2 swing
no of shelf	2	4
height (mm)	1000	1950
width (mm)	1000	1000
depth (mm)	500	500